

IN2IT social

User guide v 3.3

Introduction.....	2
1. Access IN2IT social user interface.....	2
General overview of the IN2IT social interface	3
2. Search	4
2.1. Trending topics.....	4
2.2. Search by Location.....	4
2.3 Search by Keywords.....	5
2.4 Search by lists of Twitter accounts.....	5
2.5 Advanced search	7
2.6 Saved searches	8
3. Preview and selection of search results.....	9
4. Direct ingest from URL.....	10
5. Ingest profile selection and metadata filling.....	11
5.1. Ingest profile	11
5.2. Metadata.....	11
6. Monitoring	11
7. Google Chrome plugin.....	12



Introduction

IN2IT social is a software designed for journalists and operators, that allows to search, preview, select and process content from social networks and various web sources to their newsroom and production environment.

IN2IT social user interface is intuitive and makes everything easy, from search to ingest. It embeds the powerful search engine from Nunki.co. IN2IT social also offers a Google Chrome plugin allowing users to start a process directly from the web page where the content has been published.

This document describes the user interface, the content search and the ingest procedure.

1. Access IN2IT social user interface

IN2IT social user interface is a web page reachable from any Web Browser (Google Chrome is recommended) that have access to the IN2IT social back-end service.

- ▶ You can reach the user interface with the address defined by the administrator, i.e. <https://social-eu.woody-technologies.com/ux>

You should ask your administrator to know the address of your IN2IT social instance.

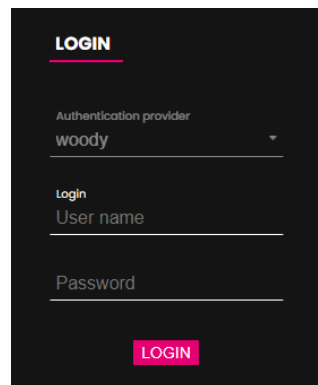

LOGIN

Authentication provider
woody

Login
User name

Password

LOGIN

General overview of the IN2IT social interface

Country selection to get trending topics

The screenshot displays the IN2IT social interface. At the top, there's a navigation bar with 'Trends' and a dropdown menu for 'United States'. Below this, a list of trending topics is shown, including '#Thanksgiving', 'Happy Pride Month', '#TMobileTuesdays', '#loveislove', 'New Month', '#uspsdayrbe', 'LGBTQ', '#TuesdaysThoughts', 'New Blessings', 'Good Tuesday', and 'New Month'. The main content area is divided into three columns: 'VolunteersWeek', 'Everton', and 'Olympics'. The 'VolunteersWeek' column features a tweet from CitizensAdviceNWKent with a graphic that says 'We couldn't do it without you.' and another tweet from Active Charmwood with a graphic that says 'A TIME TO SAY THANKS'. The 'Everton' column shows a tweet from Sokaonline with a photo of two men holding a trophy. The 'Olympics' column shows a tweet from Satohiro Akimoto with a photo of the Australian softball team and a news snippet about their arrival in Japan. On the left side, there's a sidebar with 'Select a search type' options: 'Location', 'Keywords', and 'Lists'. On the right side, there's a 'Selection' panel with a 'Monitoring' tab, a profile dropdown set to 'Paris', and a list of selected content items with 'Process' buttons.

Selection of search type

Search results area, from where content can be preview or drag and dropped to the selection area.

Selected content, start and monitor ingest tasks

2. Search

2.1 Trending topics

IN2IT social allows you to display the trending topics on Twitter for the selected region in the drop-down list menu.

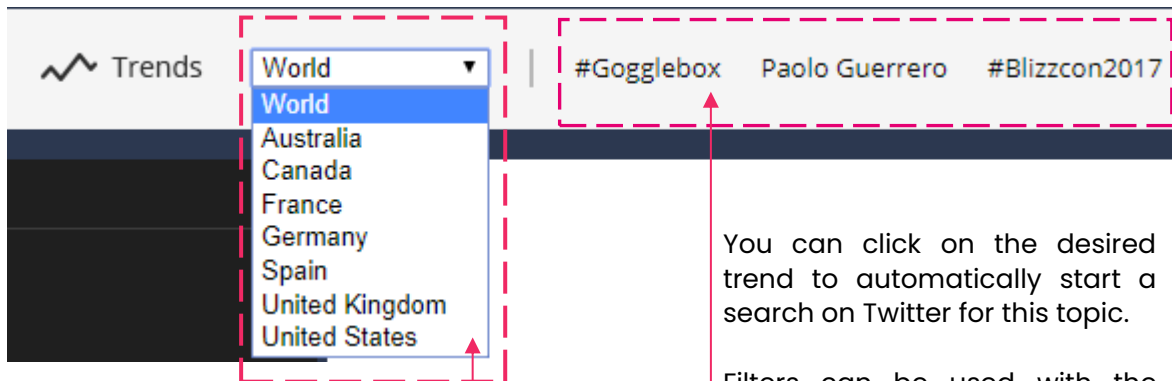

Select the desired country to display the related trends. The countries list is configured by the administrator.

You can click on the desired trend to automatically start a search on Twitter for this topic.

Filters can be used with the advanced search features (cf. §2.5)

2.2 Search by Location

Use search by Location with a searching place or use a diameter of up to 25km (15 miles) to find relevant content posted from a specific area.

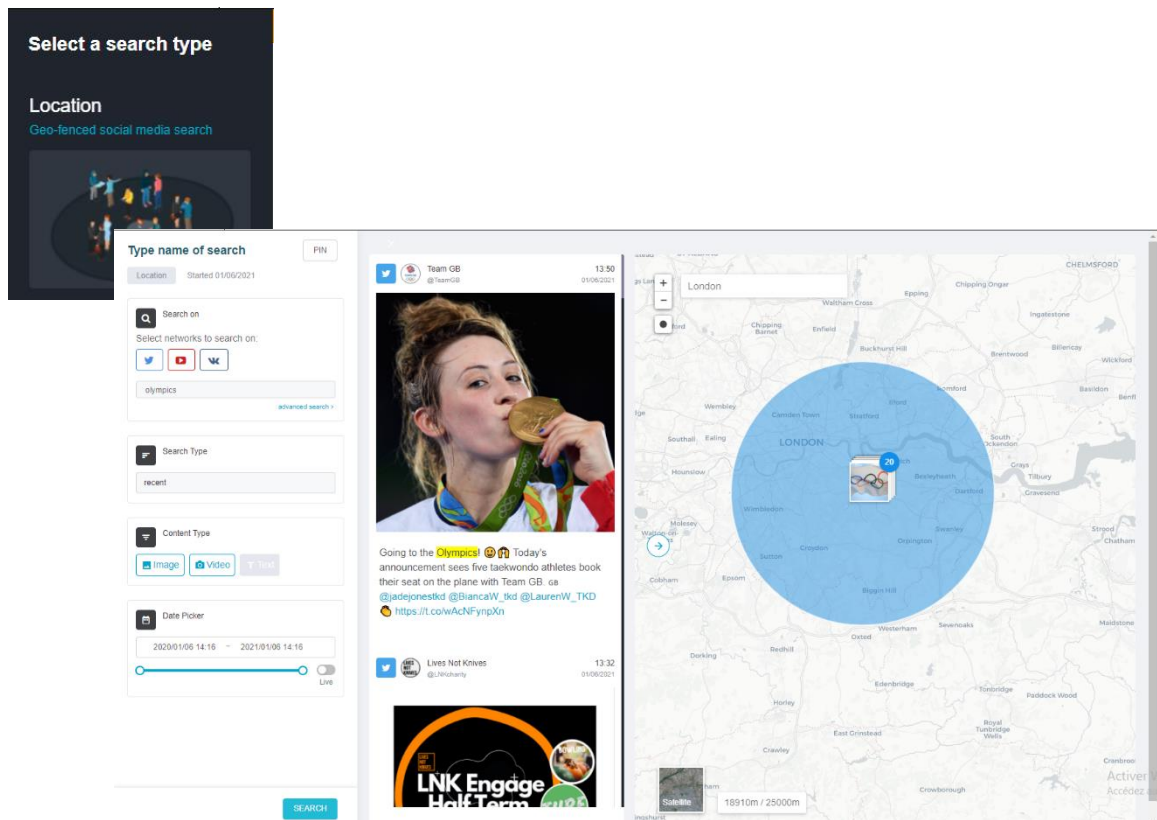

2.3 Search by Keywords

Search by Keywords and find the relative content. Select the networks to search on, choose the content type you are looking for (Image, Video or Text), select a publishing date range and choose if you prefer finding the most recent, the most relevant or the most popular content.

Select a search type

Keywords
Keyword based search

Type name of search

Keywords: Started 01/06/2021

Search on
Select networks to search on:
Twitter YouTube Instagram Facebook

Roland Garros

Content Type
Image Video Text

Date Picker
2020/01/06 14:19 - 2021/01/06 14:19

Search Type
recent

SEARCH

France tv sport 14:18
Alexs Gacon 14:17
France Bleu Sport 14:17
tenniscoaching.com 14:16

Neptunes 14:15
EL INFORMANTE 14:15
Agence France-Presse 14:15
BAHIS BORSASI(EX... 14:12

Casino Magic 14:11
Damebet 14:10
Brian Moshated Gon... 14:10
OnlyBets 14:10

Activiter V
Accédez au

2.4 Search by lists of Twitter accounts

You can search the trending topics based on Twitter accounts lists that you have previously created in IN2IT social.

Select a search type

Lists
Social media account search

Olympics

Lists: Started 04/06/2021

LISTS: MENTIONS

tokyo

Olympics @Olympics
6M Followers 5K Following

Special Olympics @SpecialOlympics
116K Followers 1.9K Following

#TokyoOlympics @NBCOlympics
892K Followers 2.9K Following

Olympics

#TokyoOlympics 02:01
#TokyoOlympics 21:37
#TokyoOlympics 20:35
#TokyoOlympics

Olympics 19:00
Olympics 16:00
Olympics 13:00
#TokyoOlympics

#TokyoOlympics 23:27
Olympics 21:00
Olympics 18:55
Special Olymp

Create your own lists by adding Twitter accounts you are interested in. You will be able to see the latest posts published by the accounts you have selected.

Create and name your list first.



Search for accounts with their names and add them to your list.

You can create several lists and start a search easily by selecting the right one.

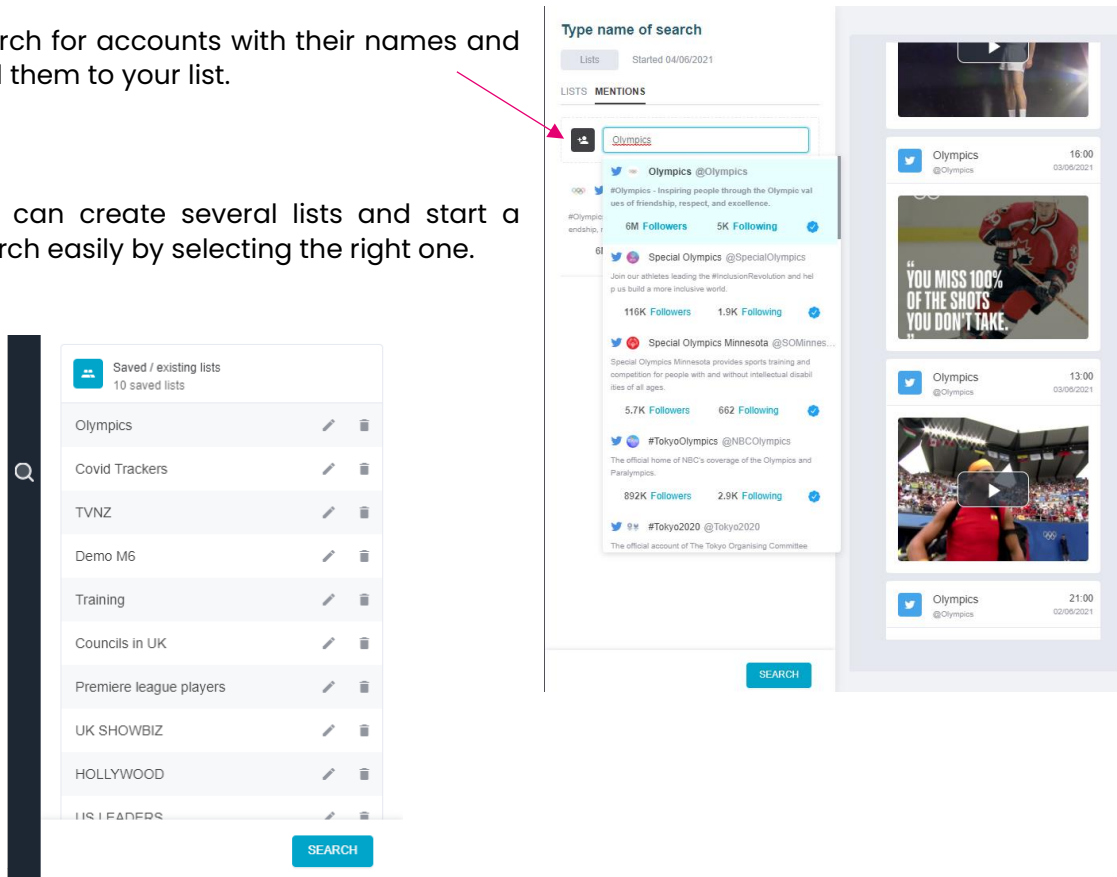

2.5 Advanced search

You can go deeper on the filtering and use the advanced search settings.

You can combine various advanced criterias to refine your search. You'll be able to select the network to search on, a publishing time window, the search type and more.

The screenshot shows the 'Advanced search' interface. At the top, there's a 'Type name of search' field and a 'PIN' button. Below that, a 'Location' field and a 'Started 01/06/2021' timestamp are visible. The main section is divided into several filter categories: 'Search on' (with icons for Twitter, YouTube, and VK), 'all of these terms' (with an 'advanced search' dropdown), 'any of these terms', 'excluding these terms' (with a 'Twitter only' note), 'Any languages', 'By' (with 'Mentioning' selected), 'Search Type' (with 'recent' selected and a dropdown menu showing 'recent', 'relevant', and 'popular'), 'Content Type' (with 'Image', 'Video', and 'Text' buttons), and 'Date Picker' (with a date range from 2020/04/06 11:00 to 2021/04/06 11:00 and a 'Live' toggle). A 'SEARCH' button is at the bottom.

Select the social networks you want to search in. Available networks can vary depending on the other criterias or on the type of search.

Exclude or add more terms to your search query.

Filter tweets by language or users.

Various sorting options are available: **Recent**, **Relevant** or **Popular** content.

Select which type of content you will look for.

Define a publishing time range here. Enable "live" to get automatic updates of your search results.



2.6 Saved searches

Want to save your search? Name your search and use the PIN button to save it on the homepage of IN2IT social. Results will be automatically updated.

Type name of search

PIN

Keywords Started 07/06/2021

Search on

Select networks to search on:

#WorldBicycleDay

Your search is pinned on the homepage. You can give it a custom name and save as many searches as you like. Saved searches are shared across your organization.

Type name of search

Bicycle

Olympics @Olympics 09:30 04/06/2021

There's no wrong way to celebrate when it's Friday! 🤪 Whether you are heading, surfing, or flipping your way into the weekend, we're with you! #FridayFeeling <https://t.co/PsyFtnmaPf>

Olympics @Olympics 19:00 03/06/2021

The Barcelona 1992 cauldron lighting is a moment we can *never* forget. 🏆 #ThrowbackThursday

PLinFinland @PLinFinland 14:38 07/06/2021

#June3WorldBicycleDay 2020

#WorldBicycleDay 2021 🚲🚲🚲 🇺🇸 Bikes are free to ride, brilliant for your physical and mental health, good for the environment and the economy! 🚲 = clean transportation 🚲 = #ClimateAction 🚲 = improved health and fitness <https://t.co/pZONYrLwEo>

İBUS @izmir_ulas 14:37 07/06/2021

Bisiklet Kullanımının Önümü Etkileri 5/8

Daha iyi KIRSAL KESİM BAĞLANTISI

Dünya Bisiklet Günü - 3 Haziran

Bisiklet kullanımı, kırsal alanlarda araba bağımlılığını azaltmaya yardımcı olur, pasif ulaşımdan aktif ulaşımaya teşvik eder. İş yerlerine ve sosyal ihtiyaçlar için alışveriş merkezlerine erişimi

3. Preview and selection of search results

Videos and photos are available from Twitter, VKontakte, Youtube and Vimeo

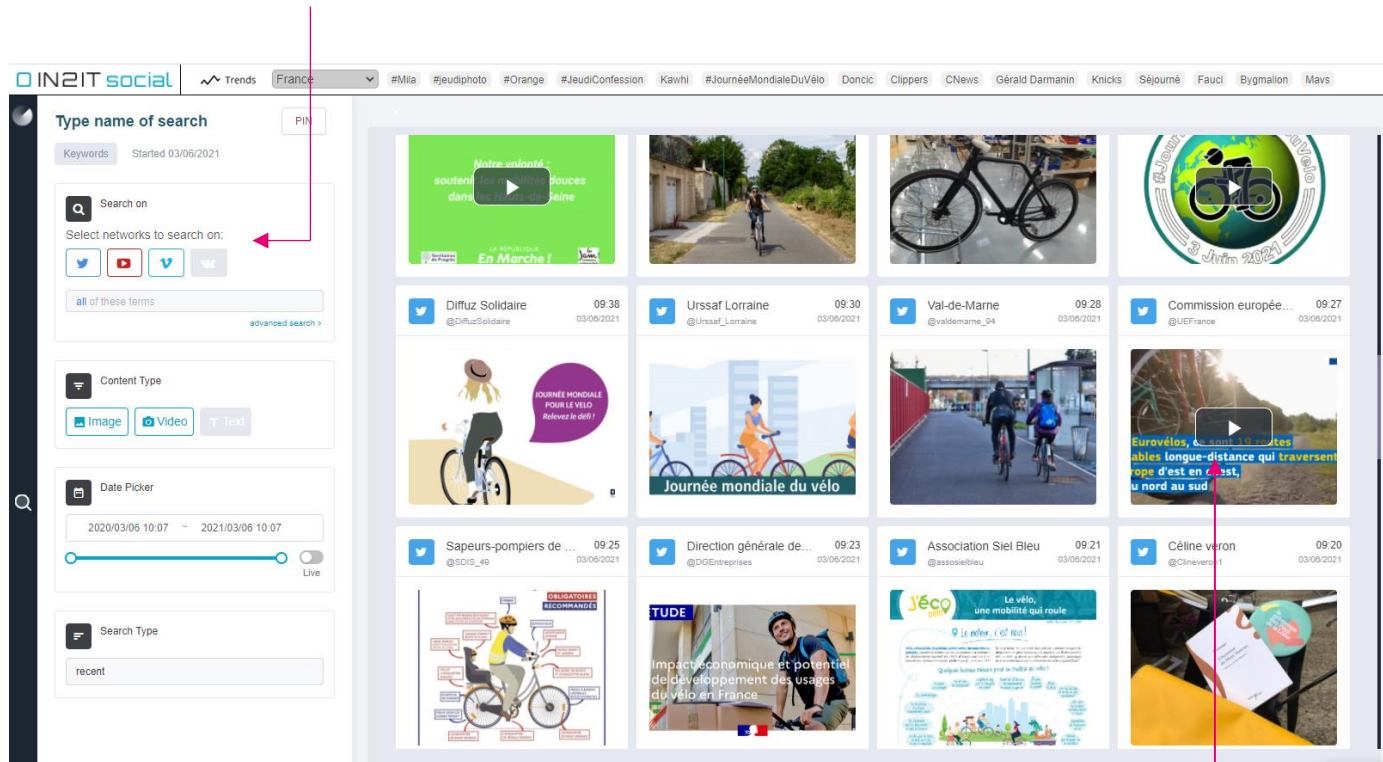

You can preview any video with a click on the thumbnail.

- ▶ See more about one result by clicking on the “details” button. This helps you knowing more about the account who posted the content (number of followers, previous posts,...) and the post itself (full description).

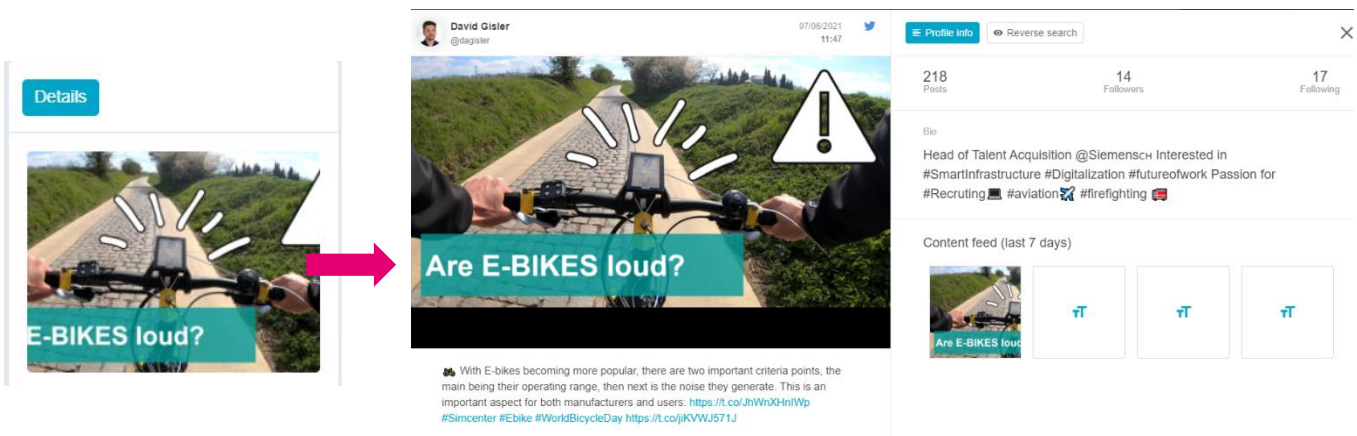

You can also use the reverse search button to check with Google if the picture or video has already been posted on a different webpage before. This is a good tool to check if the content you have found is original. If the content is geo-tagged, you can also use the “map” and “street view” features to visualize the place where the content was posted from.

- ▶ Once you have decided which content you want to work with, you simply need to drag & drop it to the selection cart, as shown on the picture bellow.

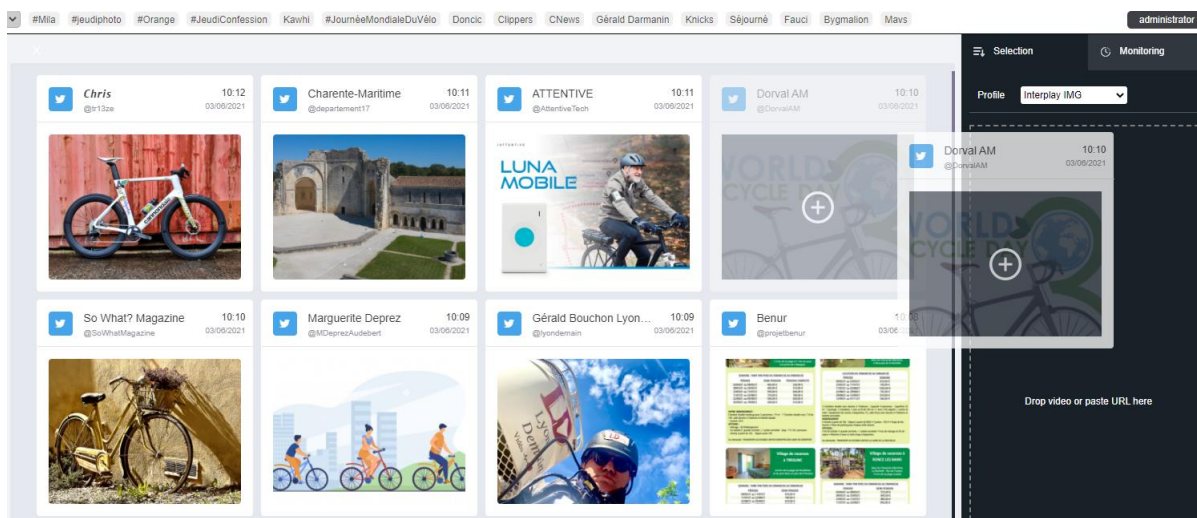

You can add as many content as you want in the selection cart before triggering the ingest.

4. Direct ingest from URL

IN2IT social allows to add content to the selection list from a website URL.

It's as easy as copy & paste **to the selection**.

- ▶ Copy the website URL

[instagram.com/p/CPI3I6unKmO/](https://www.instagram.com/p/CPI3I6unKmO/)

- ▶ And simply past in the selection area with a right click

Paste URL

You can also drag & drop a URL directly into the selection area to make it analysed.

The supported websites are listed below. Note that the media has to be available without authentication. Live feeds ingest is not supported at this moment.

Unified search



Plugin and URL ingest



and many more...

5. Ingest profile selection and metadata filing

5.1 Ingest profile

The ingest profile is configured by the administrator and contains all the ingest settings. Several profiles can be configured to handle different targets.

For each ingest profile, metadata fields can be configured by the administrator. Some fields can be mandatory.

- ▶ You have to fill them before ingest.

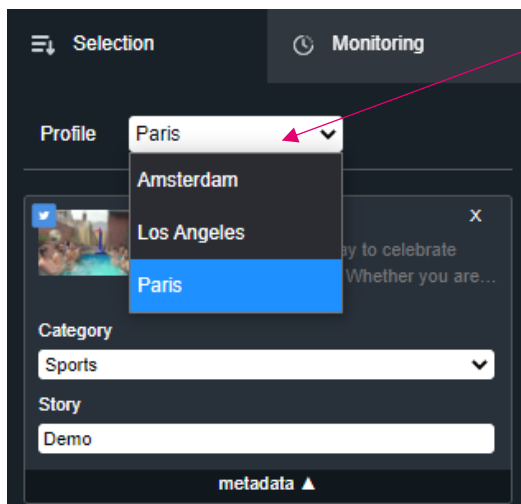

You can select the ingest profile from this dropdown menu.

i *Ingest profiles are assigned to your login. If you don't see the correct ingest profile, please contact your system administrator to check your*

Metadata fields circled in red are mandatory to complete. Metadata can be free text or dropdown lists.

5.2 Metadata

Why metadata is so important to fill? Based on the metadata you will set, the videos or photos that you want to be ingested will be well named and organized in the target environment.

Indeed, the administrator can configure naming and grouping rules based on the metadata you will fill. Therefore, it will be easier for you to find your contents in the asset management system or on the production storage.

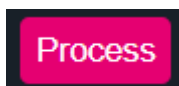

- ▶ Click on this button to trigger the ingest.

6. Monitoring

You are almost done! You can check in the monitoring tab if your files went through.

On the right-hand side of the page you can see the monitoring. If something went wrong, the progress bar will be red. If your content was processed successfully, the progress bar will be in green.

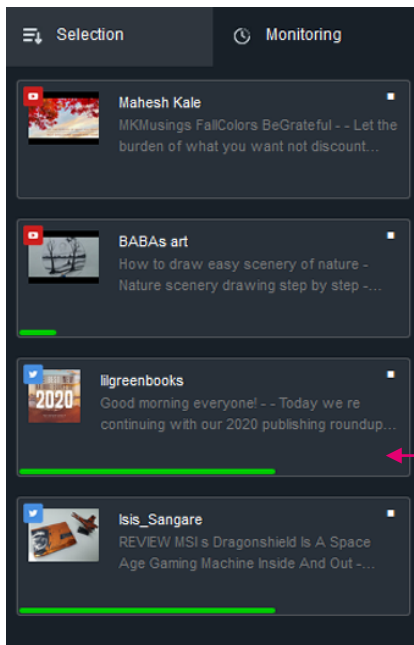

► You can **right click** on a thumbnail to open the source url in a new tab, or reprocess the content.

Job progress

7. Google Chrome plugin

IN2IT **social** plugin for Google Chrome allows you to find out if the website you are navigating on is compatible, and to trigger processing of a photo or video directly from the web page. The extension allows you to choose your ingest profile, add metadata and monitor the process.

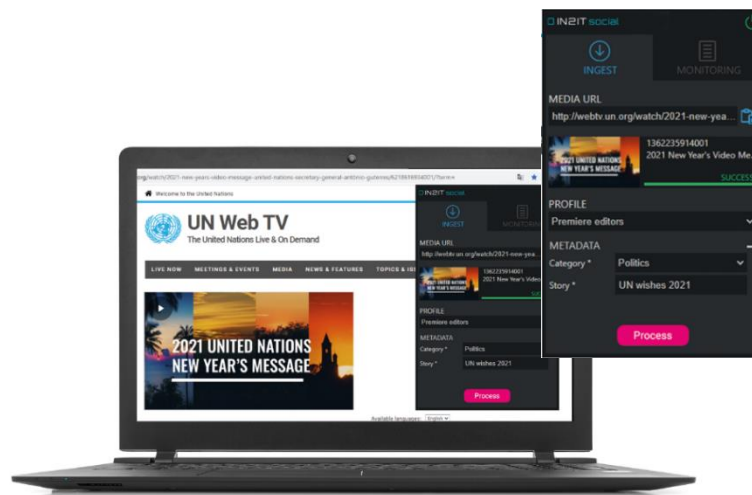

► Download the extension on the Chrome Web Store and add it to your browser:

<https://chrome.google.com/webstore/detail/in2it-social/kphbkijmjbcddfjffikgdngoibfiafnc?hl=en>

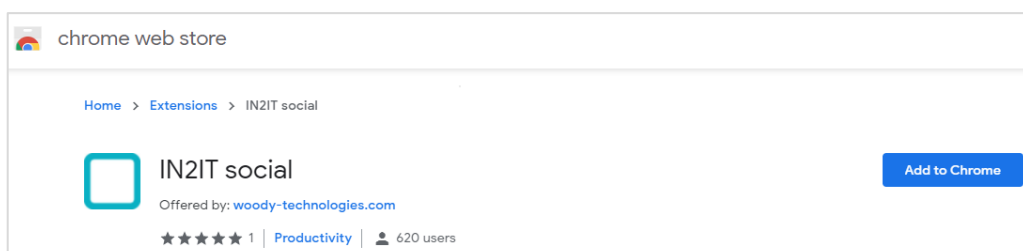

- ▶ Connect to the server endpoint

You should ask your administrator to know the address and credentials of your **IN2IT social** instance.

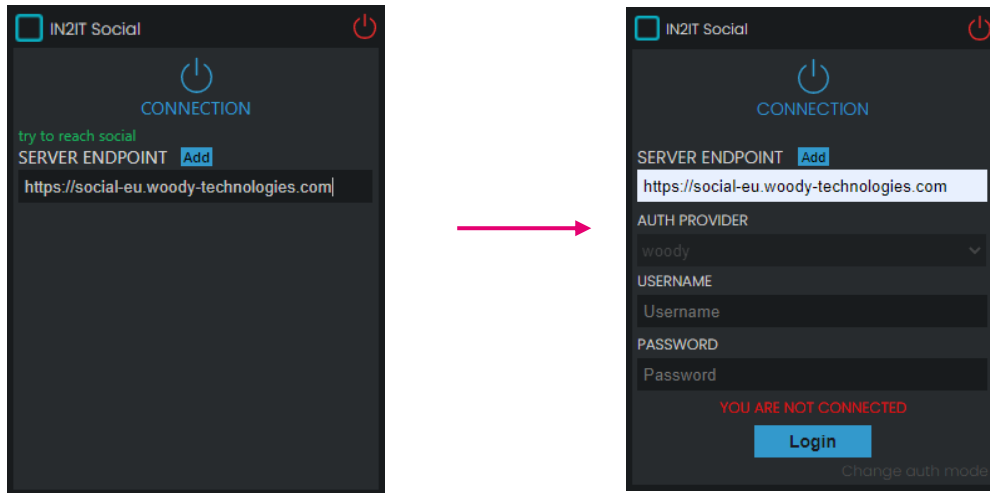

The blue square icon of **IN2IT social** will appear in your extensions bar.

The plugin starts to analyze the navigation URLs after login (if you are already on the page, you need to reload after login). It turns filled with blue if the website is compatible:

instagram.com/cats_of_instagram/



When clicking on the icon, the URL is analyzed and the source metadata is extracted if possible.

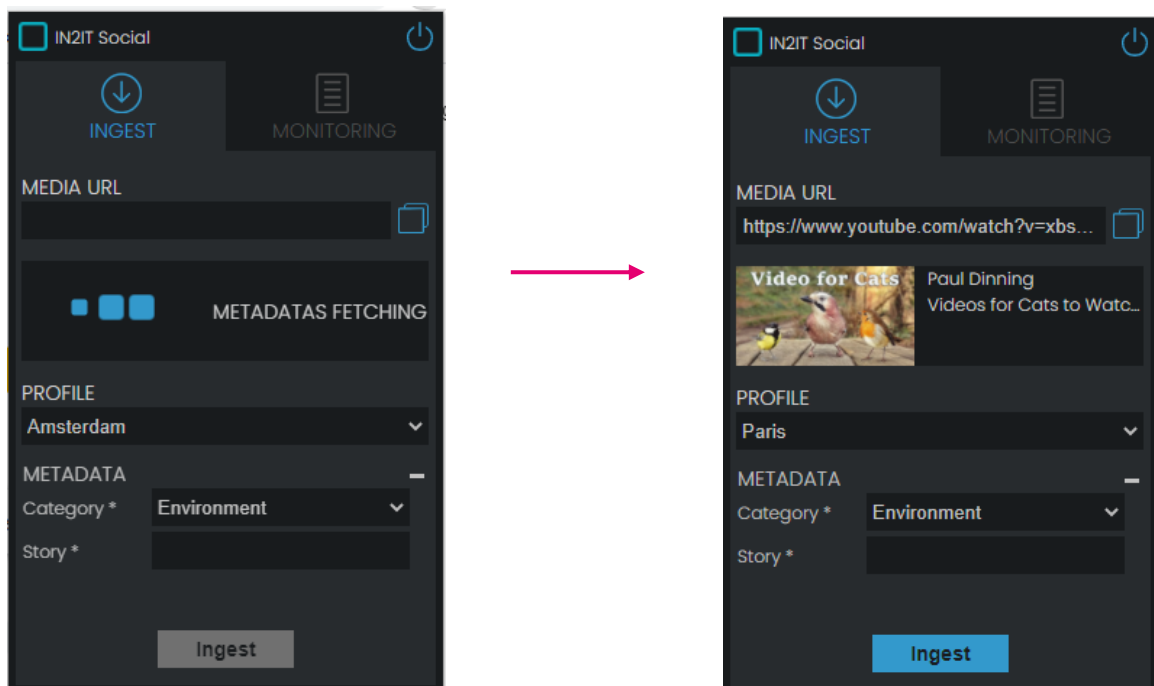

- ▶ Fill the metadata
- ▶ Trigger Ingest and monitor the result

